

WASHINGTON STREET

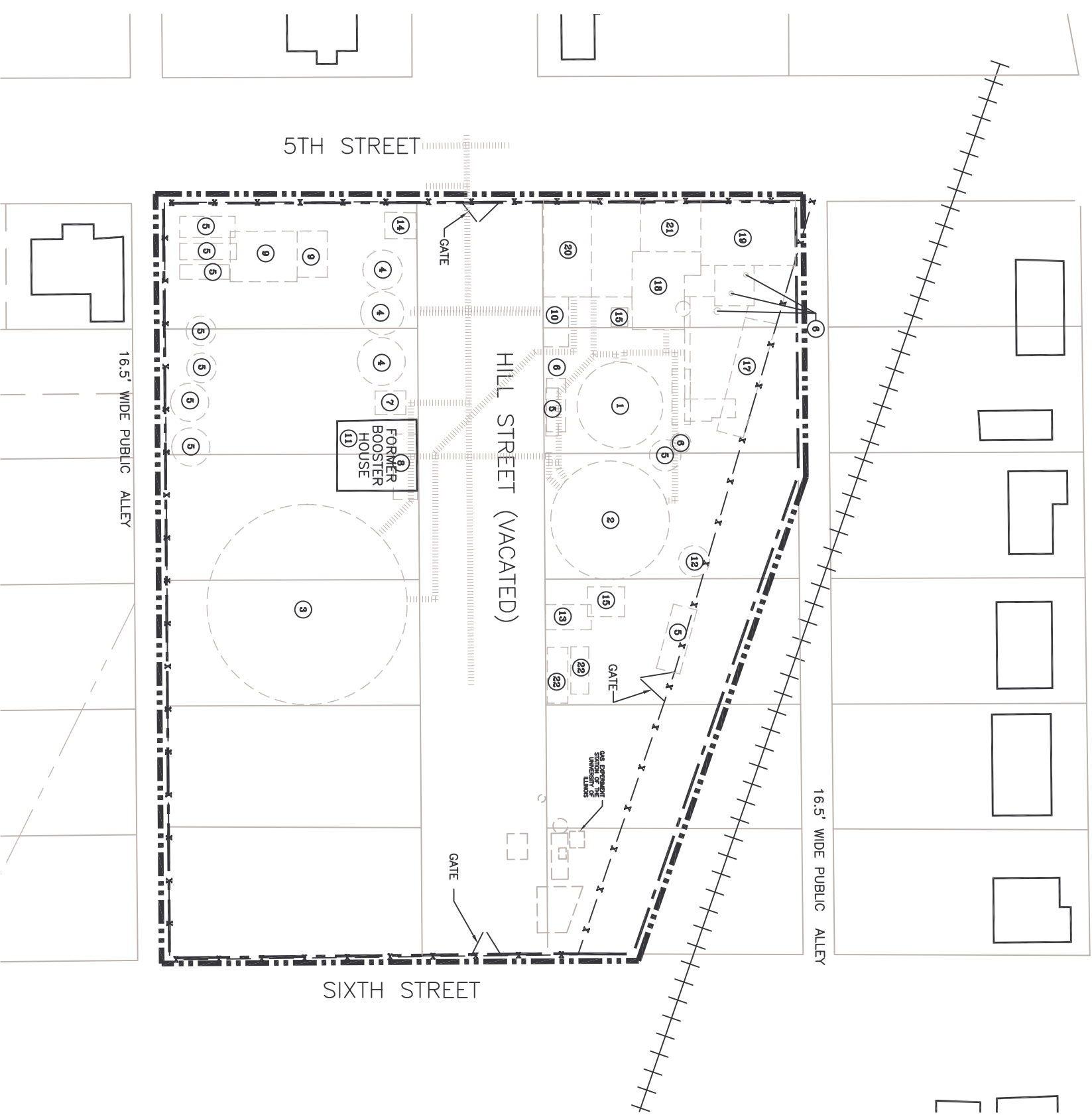

LEGEND

- HISTORICAL MANUFACTURED GAS PLANT STRUCTURES
- FORMER GAS PLANT PIPING
- EXISTING STRUCTURES (APPROXIMATE)
- CURRENT AMERENIP PROPERTY BOUNDARY
- REMEDIATION SITE BOUNDARY
- LOT LINE
- x- FENCE
- ① GAS HOLDER GH-1
- ② GAS HOLDER GH-2
- ③ GAS HOLDER GH-3
- ④ PUFFER
- ⑤ OIL TANK
- ⑥ TAR SEPARATOR
- ⑦ SCRUBBER
- ⑧ BOOSTER
- ⑨ METER SHOP
- ⑩ OFFICE
- ⑪ PUMP HOUSE
- ⑫ SETTLING TANK
- ⑬ PUMP HOUSE / DEHYDRATOR HOUSE
- ⑭ TOOL ROOM / OFFICE / GARAGE
- ⑮ CRUSHER HOUSE
- ⑯ WELL HOUSE
- ⑰ COAL SHED
- ⑱ WATER GAS ROOM
- ⑲ RETORTS
- ⑳ PURIFYING ROOM
- ㉑ CONDENSING ROOM
- ㉒ OIL TANK / TAR WELL
- ㉓ BOILER ROOM

NOTE: THE HISTORICAL MANUFACTURED GAS PLANT STRUCTURES ARE A COMPOSITE FROM SANBORN FIRE INSURANCE MAPS AND HISTORICAL AMERENIP SITE PLANS. THE EXACT LOCATIONS OF THE STRUCTURES IS NOT KNOWN. STRUCTURES AND BUILDINGS MAY HAVE SERVED MULTIPLE PURPOSES DURING THE OPERATION OF THE PLANT.

SOURCE: THE SOURCE FOR THE PROPERTY BOUNDARY SURVEY IS VEGRZYN, SARVER AND ASSOCIATES.



NO.	REVISION	BY	APPR.	DATE

PROJECT TITLE
CHAMPAIGN MGP SITE
CHAMPAIGN, ILLINOIS
AMERENIP

SHEET TITLE
HISTORICAL MANUFACTURED
GAS PLANT BUILDINGS
AND STRUCTURES

DATE	3/23/06	DRAWN BY	TMM	DRAWING NO.	FIGURE 6-1
PROJECT NUMBER	62402647	CHECKED BY			
		APPROVED BY			

