

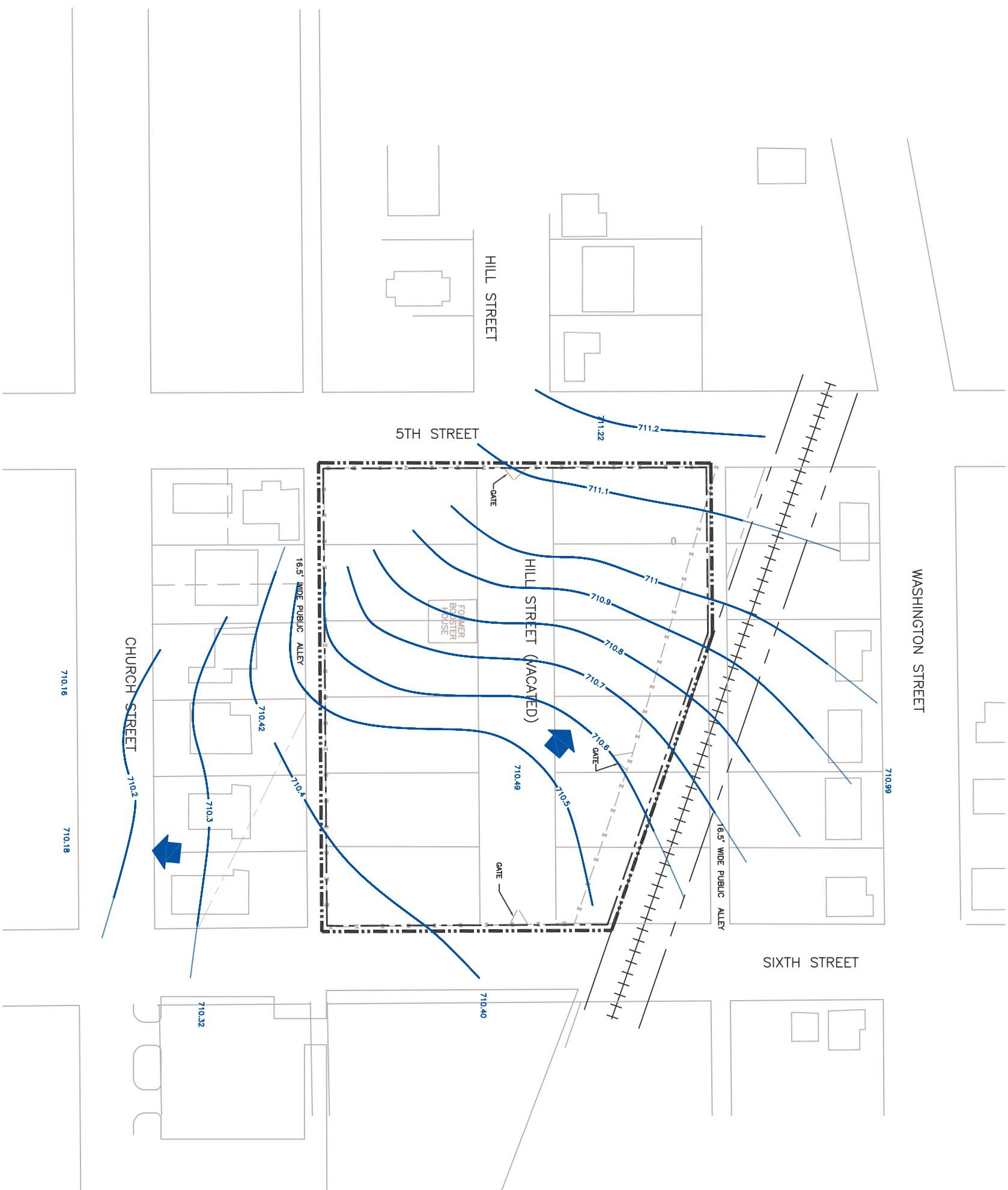

TITLE:  
 INTERMEDIATE DEPTH POTENTIOMETRIC SURFACE MAP  
 JULY 10, 2008



LEGEND

- HISTORICAL MANUFACTURED GAS PLANT STRUCTURES (APPROXIMATE)
- ..... FORMER GAS PLANT PIPING (APPROXIMATE)
- EXISTING STRUCTURES (APPROXIMATE)
- - - CURRENT AMERENIP PROPERTY BOUNDARY
- ▬ REMEDIATION SITE BOUNDARY
- - - - - FENCE
- ⊕ UMW-300 710.99 INTERMEDIATE GROUNDWATER MONITORING WELL WITH GROUNDWATER ELEVATION
- ➔ GROUNDWATER FLOW DIRECTION

NOTE: THE HISTORICAL MANUFACTURED GAS PLANT STRUCTURES ARE A COMPOSITE FROM SANBORN FIRE INSURANCE MAPS AND HISTORICAL AMERENIP SITE PLANS. THE EXACT LOCATIONS OF THE FEATURES ARE NOT KNOWN. STRUCTURES AND BUILDINGS MAY HAVE SERVED MULTIPLE PURPOSES DURING THE OPERATION OF THE PLANT.

SOURCE: THE SOURCE FOR THE PROPERTY BOUNDARY SURVEY IS VEGRZYN, SARVER AND ASSOCIATES.



DWN:	TMM	DES:	MRC	PROJECT NO:	62403053
CHKD:		APPD:		AMERENIP CHAMPAIGN, ILLINOIS	
DATE:	7/24/08	REV:		FIGURE 2-4	